



# Designing Physneyland

## Future Focused Learning Spaces



The Scots College

# Overview

- Introduction of presenters
- Theoretical Background in ABL and Collaborative Learning
- Scenario outline
- Veldhoen Process
- Designing space activity
- Presentations and feedback
- The Scots Experience



# The Presenters

Chris Metcalfe BSC, Dip ED, MBA

- Dean of Applied Science, The Scots College
- Senior physics teacher (13 years)

Eric Gibbings B.Sc, Dip Ed, MEd

- Master Teacher (Science), The Scots College
- 39 years experience teaching physics



# Changing Education??

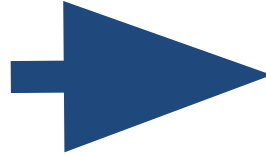
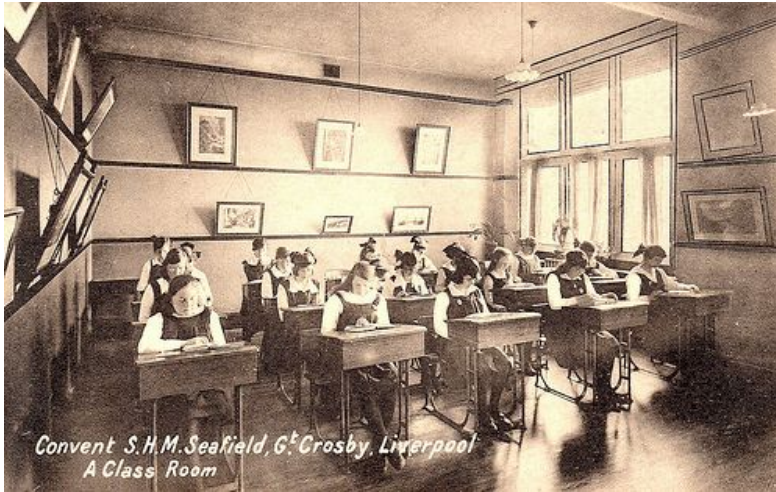

# Global Trends

- Experiential (Problem-based, inquiry-based)
- Collaborative Learning
- Negotiated/individualised
- Interactive
- New approaches to assessment of learning (formative, individualised, portfolio)
- Knowledge → Skills
- Metacognition (Powerful and Empowered Learners)
- Creativity/Innovation



# ABW and Collaborative Working



# ABW and Collaborative Learning





# 21st Century Learning

**collaborate** **create** **connect** **Learning** **communicate**

Look Knowledge motivate Watch Write  
Listen Original work responsibility Worldwide  
care inspire peers Previous knowledge understanding  
Ideas Concept curiosity geographic borders Remix ideas  
Personal Learning Network  
Local socio-economic backgrounds  
Read Present respect Sharing  
experts cultural boundaries Illustrate





# Challenge Scenario

- Social Sciences learning space
- 4 classes (100 students)
- Existing building
  - Arrangement of space
  - Furniture requirements
  - White boards, smart boards
  - Information Technology
  - Partitions



# Veldhoen

- Aspiration (Philosophy)
- Activities (Present and future)
- Functional Areas (Places to “do” and “be”)



# Philosophy

## EDUCATIONAL PHILOSOPHY



# Activities



# Functional Areas



*"re-imagining the learning spaces"*



# Team Design Challenge

- Teams for different functional areas
- Materials provided
- Teams create models of functional areas based on parameters





# Share and Discuss



# The Scots Experience



# 3 Aspects

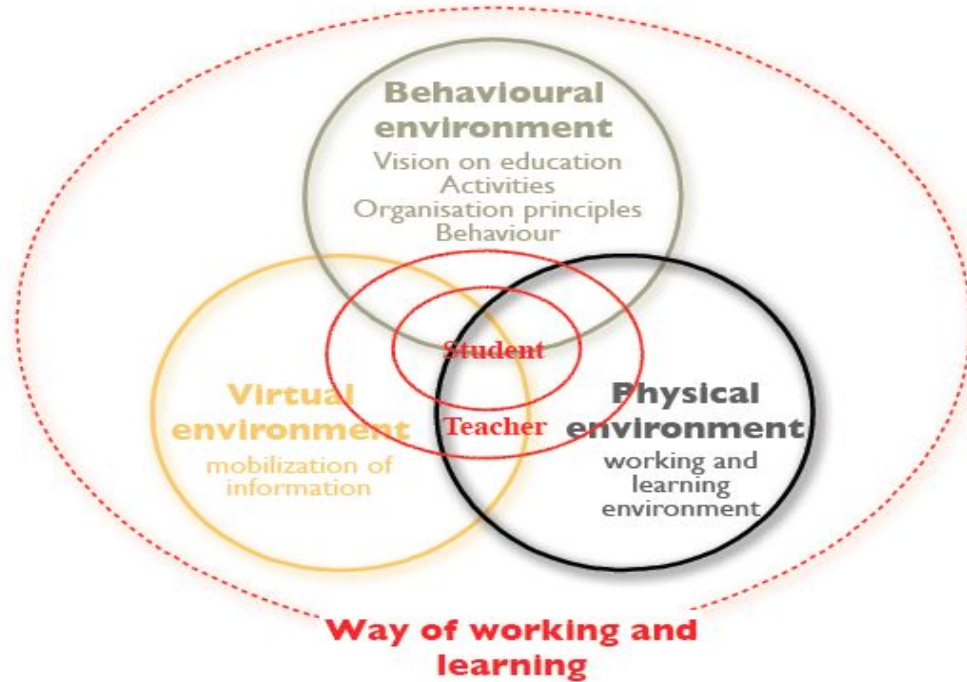

# Activity types

What activities do the students do?



Lecture



Prac

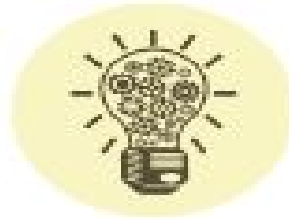

Create



Focus



# Activity Settings - Lecture

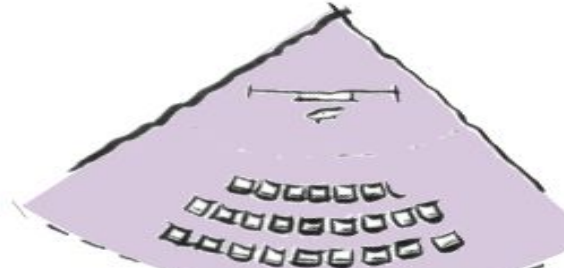

*Science themed seating, Environmental materials (cardboard)*



*Carpet Steps creates a soft feel (possibly less noise)  
Shape enables more people in the 'front row'*



# Activity Settings - Prac





# Activity Settings - Create

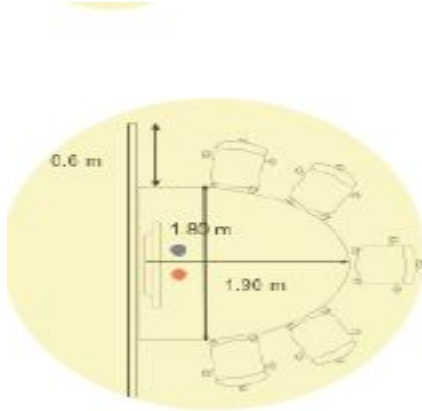

*Screening option*



*Alternate structure with large screen on desk*





## Group Create

### Indicative sketches and imagery



*Create Brainstorm/ with writing surfaces/ possible smart board*



*Create and Share/ Group Chat  
Some privacy screening/*



*Casual seating Chat with  
chairs that wrap around*



# Activity Setting - Focus



Focus  
Indicative sketches and imagery



*High bench with stools or normal seating and power.  
Scots solution desire monitors.*

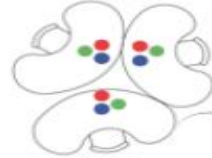
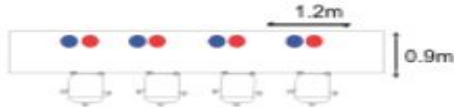

*Personal workstations that wrap around the user and have screening for privacy. Can also sit to stand to provide an ergonomic worksetting for longer working. Space for external monitor.*



• Data



# Zoning

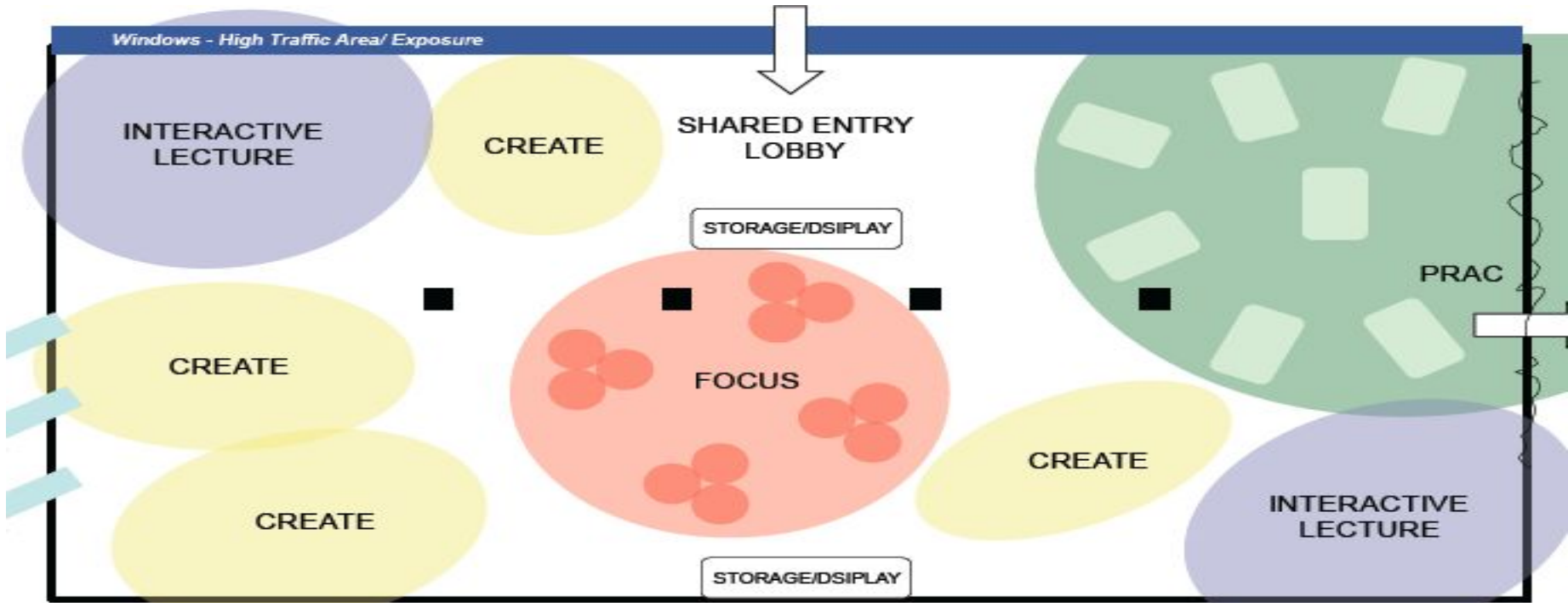



# Plans

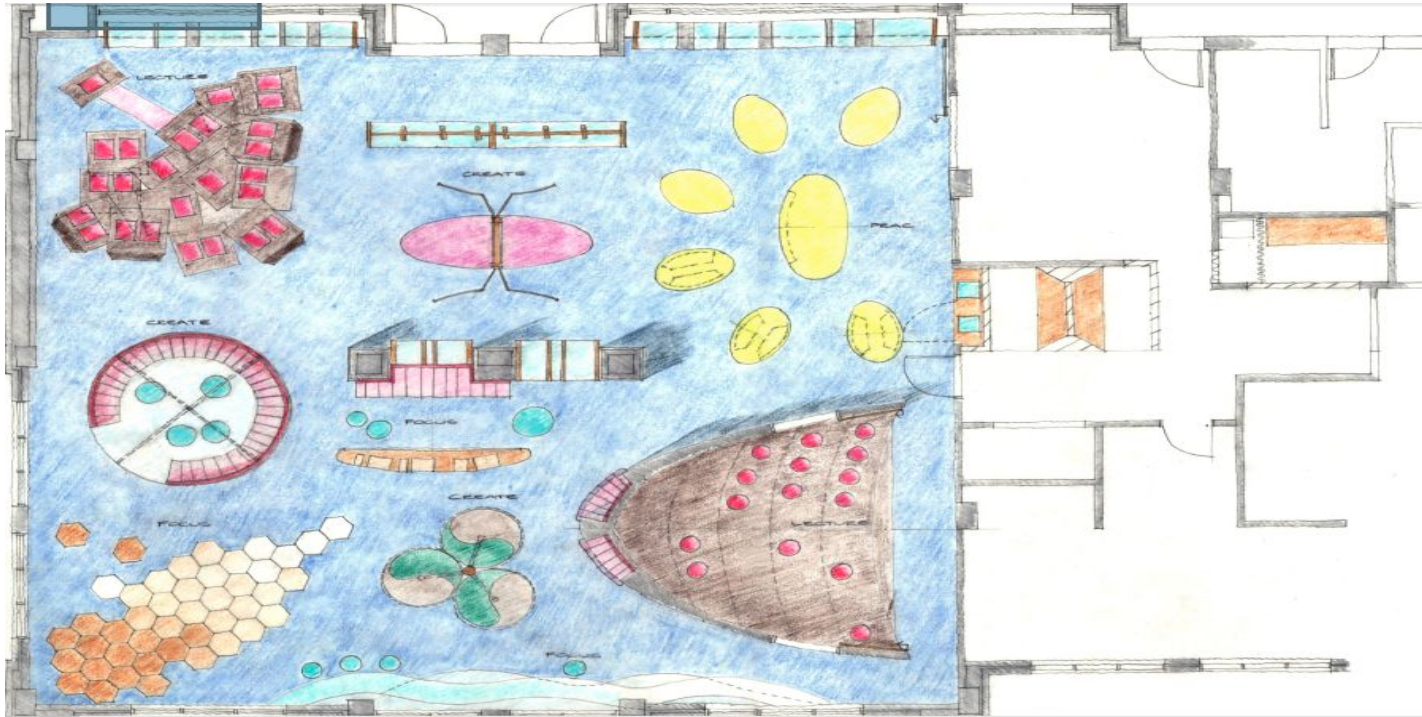

# Vision

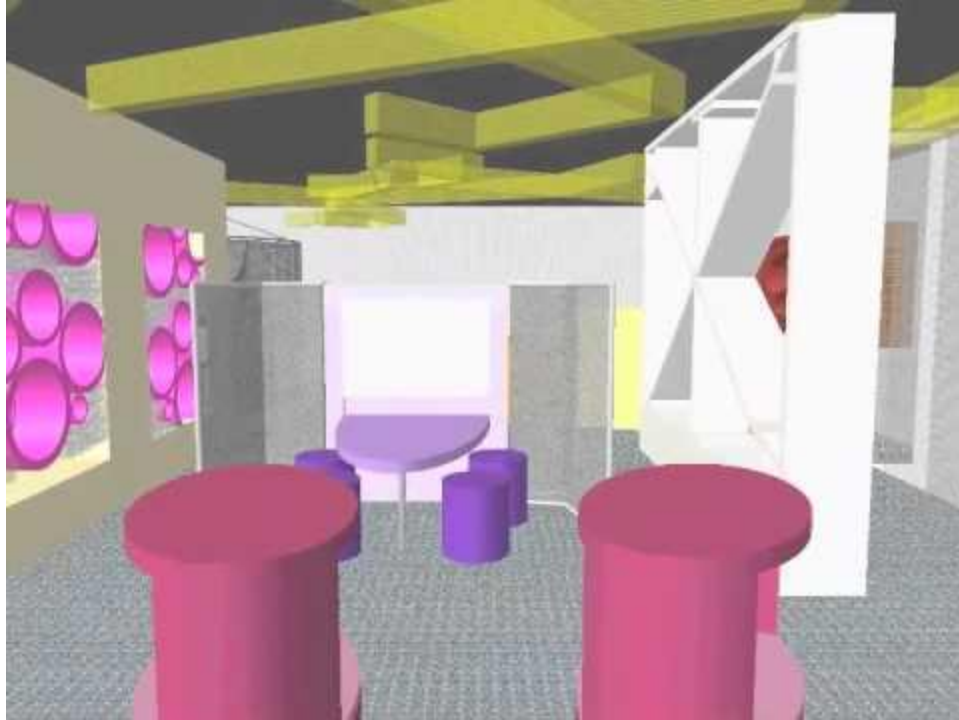



# Challenges - Behavioural

- Changes for students and teachers
- Ownership for students
- Teachers help hold them accountable
- Collaboration, individual
- Using IT effectively
- More ..... Less.....
- Looking forward to the challenge



# References

Blackmore, J., Bateman, D., Loughlin, J., O'Mara, J., & Aranda, G. (n.d.). *Research into the connection between built learning spaces and student outcomes*.

*Designing spaces for effective learning: A guide to 21st century learning space design*. (2006). London: HEFCE.

Harris, S (2010). *The Place of Virtual, Pedagogic and Physical Space in the 21st Century Classroom*, SYDNEY CENTRE FOR INNOVATION IN LEARNING

Oblinger, D. (2006). *Learning spaces*. Boulder, CO: EDUCAUSE.

Retrofitting Uni Learning Spaces. (n.d.). Retrieved June 05, 2016, from <http://learnline.cdu.edu.au/retrofittingunispace/index.html>

Scott-Webber, L. (2004). *In sync: Environmental behavior research and the design of learning spaces*. Ann Arbor, MI: Society for College and University Planning.

Zautsen, Sheila (2013). *ABW vs ABL*. Initial Briefing for The Scots College. Veldhoen + Company

